

Discovery Tree



VTech understands that a child's needs and abilities change as they grow and with that in mind we develop our toys to teach and entertain at just the right level...

Electronic Learning Computers

Cool, aspirational and inspiring computers for curriculum related learning

Pre-School

Interactive toys to develop their imagination and encourage language development

vtech Baby

Toys that will stimulate their interest in different textures, sounds and colours

I am...

...responding to colours, sounds and textures

...understanding cause and effect

...learning to touch, reach, grasp, sit-up, crawl and toddle

I want...

...to get ready for school by starting to learn the alphabet and counting

...my learning to be as fun, easy and exciting as can be

...to show my creativity with drawing and music so my whole brain develops

I need...

...challenging activities that can keep pace with my growing mind

...intelligent technology that adapts to my level of learning

...National Curriculum based content to support what I'm learning at school

Birth-36 months



3-6 years



4-10 years



To learn more about this and other VTech® products, visit www.vtech.co.uk

INTRODUCTION

Thank you for purchasing the VTech® **Discovery Tree** learning toy.

The VTech® **Discovery Tree** features five fun learning activities that encourage your child to explore. Press the buttons, turn the disk, insert the shapes and turn the page to discover phonics, letters, colours, animals, shapes, fruit, numbers and more.

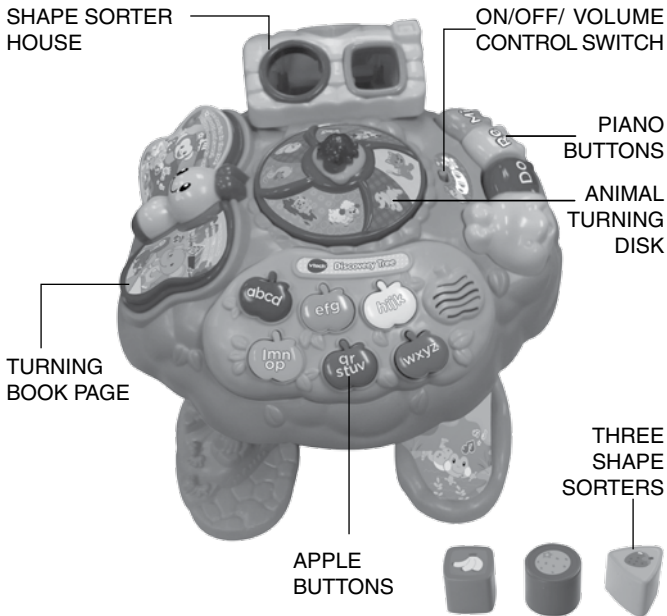

INCLUDED IN THIS PACKAGE

- One VTech® Discovery Tree play panel
- One Tree trunk (up)
- One Tree trunk (down)
- One branch of the tree base
- Three shape sorter blocks
- Ten screws
- One instruction manual

WARNING: All packing materials, such as tape, plastic sheets, packaging locks and tags are not part of this toy, and should be discarded for your child's safety.

NOTE: Please keep this instruction manual as it contains important information.

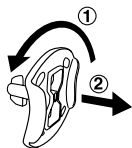

① Rotate the packing locks 90 degrees counter-clockwise

② Pull out the packing locks

GETTING STARTED

BATTERY INSTALLATION

1. Make sure the unit is turned **OFF**.
2. Locate the battery cover on the back of the tree play panel on the unit. Use a coin or a screwdriver to loosen the screw.

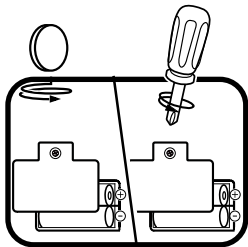

3. Install 2 new AA (LR6/AM-3) batteries following the diagram inside the battery box. (The use of new alkaline batteries is recommended for maximum performance.)
4. Replace the battery cover and tighten the screw to secure.

BATTERY NOTICE

- Use new alkaline batteries for maximum performance.
- Use only batteries of the same or equivalent type as recommended.
- Do not mix different types of batteries: alkaline, standard (carbon-zinc) or rechargeable (Ni-Cd, Ni-MH), or new and used batteries.
- Do not use damaged batteries.
- Insert batteries with the correct polarity.
- Do not short-circuit the battery terminals.
- Remove exhausted batteries from the toy.
- Remove batteries during long periods of non-use.
- Do not dispose of batteries in fire.
- Do not charge non-rechargeable batteries.
- Remove rechargeable batteries from the toy before charging (if removable).
- Rechargeable batteries are only to be charged under adult supervision.

Disposal of batteries and product



The crossed-out wheellie bin symbols on products and batteries, or on their respective packaging, indicates they must not be disposed of in domestic waste as they contain substances that can be damaging to the environment and human health.



The chemical symbols Hg, Cd or Pb, where marked, indicate that the battery contains more than the specified value of mercury (Hg), cadmium (Cd) or lead (Pb) set out in Battery Directive (2006/66/EC).

The solid bar indicates that the product was placed on the market after 13th August, 2005.

Help protect the environment by disposing of your product or batteries responsibly.

For more information, please visit:

www.recycle-more.co.uk

www.recyclenow.com

ASSEMBLY INSTRUCTIONS

With the **VTech® Discovery Tree** safety comes first. To ensure your child's safety, adult assembly is required.

1. Place the tree trunk (up) onto the tree trunk (down) and use 4 screws to fix them together.

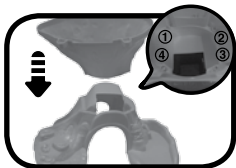

2. Place the tree trunk onto the tree play panel and use 4 screws to fix them together.



3. Place the branch of the tree base (4) onto the tree base and use 2 screws to fix them together.

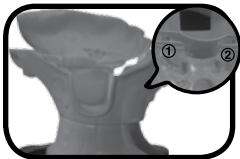

PRODUCT FEATURES

1. ON/OFF/VOLUME CONTROL SWITCH

To turn the unit **ON**, slide the **ON/OFF/VOLUME CONTROL SWITCH** to the **LOW VOLUME** (🔊) or the **HIGH VOLUME** (🔊🔊) position. To turn the unit **OFF** (🔇), slide the **ON/OFF/VOLUME CONTROL SWITCH** to the **OFF** (🔇) position.



2. AUTOMATIC SHUT OFF

To preserve battery life, the **VTech® Discovery Tree** will automatically power-down after approximately 45 seconds without input. The unit can be turned on again by pressing any button.

ACTIVITIES

- 1 Slide the on/off/volume control switch to turn the unit on. You will hear a playful sound, a song and a fun phrase. The lights will flash with the sounds.



- 2 Press the apple buttons to learn colours and phonics. Press multiple apple buttons to hear fun sounds and sing-along songs. The lights will flash with the sounds.



3. Rotate the turning disk by hand to hear fun sounds. When the disk is turned slowly, you will hear animal facts, singing animals or melodies. When rotating the turning disk by hand quickly and continuously, you will hear animals saying hello. When the disk is fully turned more than once you will hear sing-along songs. When in an unknown zone, you will hear a giggle. The lights will flash with the sounds.



4. Insert the shapes into the shape sorter house to learn shapes and fruit. The lights will flash with the sounds.



5. Turn the book page to hear fun songs. The lights will flash with the sounds.



6. Press the light-up piano buttons to hear fun sounds and learn numbers and music notes. Quickly press the buttons to play piano notes. When a melody is playing, press the buttons to play the melody one note at a time. The lights will flash with the sounds.



Sing-Along Song Lyrics

SONG 1

So much to play with on the tree,
Come and we'll have fun.

SONG 2

A says Aa and B says Buh, C says Kuh, D says Duh;
E says Eh and F says Fff, G says Guh;
H says Huh and I says Ih, J says Juh, K says Kuh;
L says Lll, M says Mmm, N says Nnn, O says Oh and P says Puh;
Q says Kwuh, and R says Rrr, S says Sss, T says Tuh, U says uh and
V says Vuh;
W says Wuh, X says Ks, Y says Yuh and Z says Zzz.

SONG 3

Apples hanging in the tree,
Colourful and sweet,
Ready for someone to eat.

SONG 4

Turn turn turn the dial, turn it 'round, you'll hear a sound,
Can you guess who it is?

MELODY LIST:

1. Alphabet song
2. Animals Fair
3. Bingo
4. Hey Diddle Diddle
5. Old MacDonald
6. Three Little Kittens
7. Skip to My Lou
8. Row Row Row Your Boat
9. London Bridge
10. Turkey in the Straw
11. Yankee Doodle
12. Farmer in the Dell
13. Hickory Dickory Dock
14. Hot Cross Buns
15. Old King Cole

CARE & MAINTENANCE

1. Keep the unit clean by wiping it with a slightly damp cloth.
2. Keep the unit out of direct sunlight and away from any direct heat source.
3. Remove the batteries when the unit is not in use for an extended period of time.
4. Do not drop the unit on hard surfaces.

TROUBLESHOOTING

If for some reason the program/activity stops working or malfunctions, please follow these steps:

1. Please turn the unit **OFF**.
2. Interrupt the power supply by removing the batteries.
3. Let the unit stand for a few minutes, then replace the batteries.
4. Turn the unit **ON**. The unit should now be ready to play again.
5. If the product still does not work, replace with an entire set of new batteries.

If the problem persists, please call our Consumer Services Department on 01235 546810 (from UK) or +44 1235 546810 (outside UK) and a service representative will be happy to help you.

IMPORTANT NOTE:

Creating and developing **VTech®** products is accompanied by a responsibility that we take very seriously. We make every effort to ensure the accuracy of the information which forms the value of our products. However, errors sometimes can occur. It is important for you to know that we stand behind our products and encourage you to call our Consumer Services Department on 01235 546810 (from UK) or +44 1235 546810 (outside UK) with any problems and/or suggestions that you might have. A service representative will be happy to help you.

**CLASS 1
LED PRODUCT**



PRODUCT WARRANTY



Thank you for choosing this quality product from VTech. We hope it will bring many hours of entertainment, imaginative play and learning.

1. The product detailed above is covered by a one year warranty from the date of purchase, against any defects in materials or workmanship.
2. The product may be returned to the place of purchase. Alternatively the product can be returned to VTech Electronics Europe plc (see address below), with proof of purchase, without proof of purchase no replacement will be provided.
3. VTech Electronics Europe plc will examine the product and if it is found to be defective due to faulty materials or workmanship, will replace the product at their discretion.
4. If the product covered by this warranty is damaged due to misuse, modification or unauthorised repair, or because of faulty batteries, battery discharge or incorrect electrical connections, then this warranty becomes void.
5. This warranty is personal to the original purchaser and is not transferable.
6. Breakages to the LCD screen are not covered by the warranty.
7. Returns to VTech Electronics Europe plc should include a cheque or postal order for £1.50 towards the cost of return postage and packaging.
8. Products returned to VTech Electronics Europe plc, should be addressed as follows and packed carefully to avoid damage in transit (Please do not include batteries or adaptor).
Please include details of the fault together with your name and address.
9. To keep an online record of your warranty, please register your product online at www.vtech.co.uk/warranty

VTech Electronics Europe plc, c/o Tablogix Limited, 200 Milton Park, Abingdon, Oxon OX14 4TA

THIS WARRANTY IS OFFERED AS AN EXTRA BENEFIT AND DOES NOT AFFECT CONSUMERS' STATUTORY RIGHTS.

This warranty is valid for the UK and Eire only. For products purchased outside the UK and Eire, please contact your local distributor or place of purchase.

